

TriplePoint Labs day tanks provide a local supply of fuel for emergency generator and boiler applications. **TriplePoint Labs** provides a complete package including required level sensors, leak detection sensors, supply and return pumps (if necessary), and required connections and valves. Standard size tanks range from 25 gallons up to 600 gallons. Higher capacity tanks are available upon request.



TPL-DT

Single Wall with Rupture Basin Day Tank

Standard Features:

- UL 142 Design
- UL 142 Rupture Basin Assembly
- Level Gauge
- Emergency Vent
- 150% Containment
- Plugged Drain Connection
- High Grade Enamel Paint
- Mounting Base
- Integrated with TriplePoint Labs Fuel Handling Equipment

Optional Features:

- Multipoint electronic level sensor for pump start, pump stop, low and high levels.
- Return or Supply Pumps mounted on the Day Tank.
- UL 508A Control Panel mounted on the Day Tank.
- Integrated with Existing Equipment.
- Supply or Return Transfer Pumps can be added to the tank. See table for standard flow rates and sizes.

Benefits

- ✓ Provides a single source for all equipment related and installed on a day tank.
- ✓ Reduces installation time in the field with a factory assembled and tested package.
- ✓ Provides a compact package that minimizes space.
- ✓ Improves system reliability and performance with an engineered package.



Front View

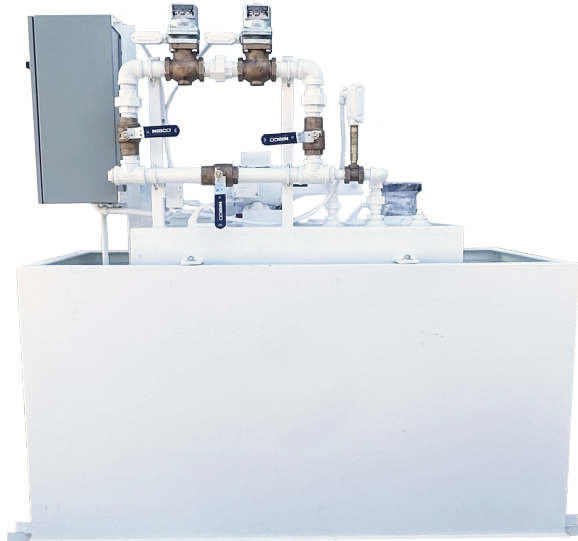

Side View

Example Electric Level Sensor

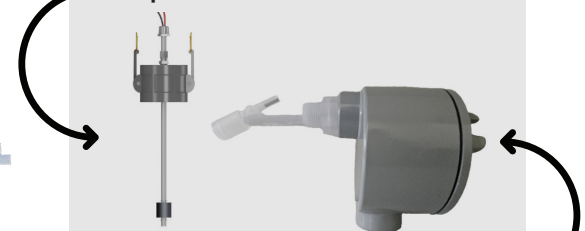

Example Electric Level Sensor

Tank Models & Dimensions

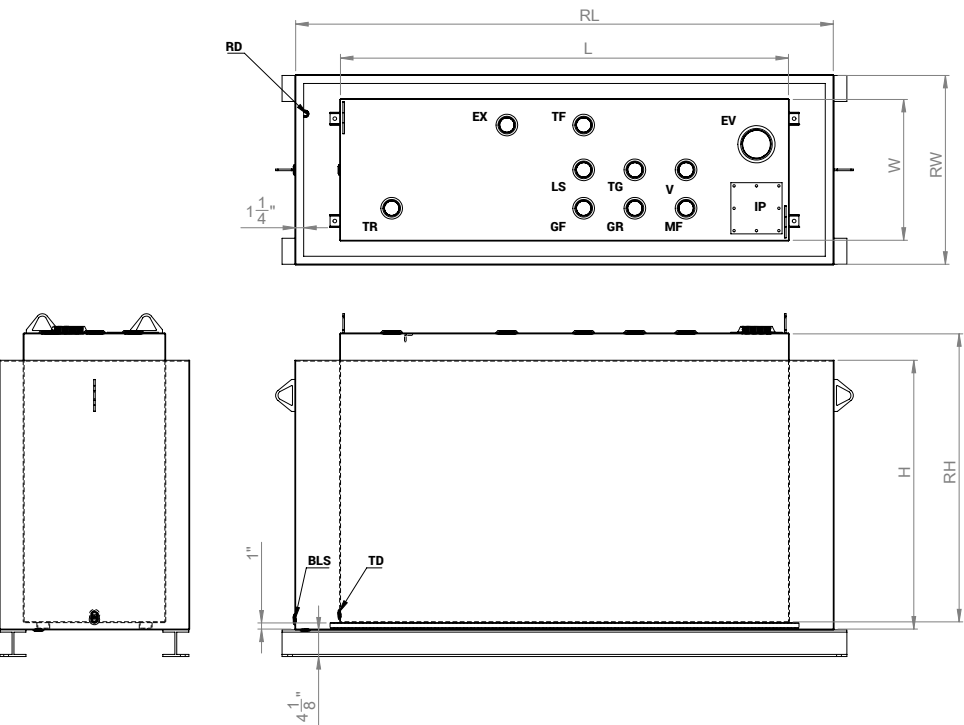

Legend

- TF Tank Fill
- TR Tank Return
- GF Generator Fill
- GR Generator Return
- V Vent
- EV Emergency Vent
- MF Manual Fill
- IP 6" Inspection Port
- LS Level Switch
- TG Tank Gauge
- EX Extra
- TD Tank Drain
- RD Rupture Drain
- BLS Basin Leak Switch

Model	Tank Capacity (gal)	W	L	H	RW	RL	RH	EV
TPL-DT-25-UL142	25	11	22	24	18.5	29.5	16	2
TPL-DT-50-UL142	50	11	35	30	18.5	43	22	2
TPL-DT-75-UL142	75	22	25	32	29.5	37	24	2
TPL-DT-100-UL142	100	22	33	32	29.5	41	29	2
TPL-DT-150-UL142	150	22	49.5	32	29.5	61	29	3
TPL-DT-200-UL142	200	22	47	45	29.5	56	42	3
TPL-DT-250-UL142	250	22	58.5	45	29.5	70	42	3
TPL-DT-300-UL142	300	22	70	45	29.5	84	42	4
TPL-DT-350-UL142	350	43	42	45	51	57	42	4
TPL-DT-400-UL142	400	43	48	45	51	65	42	4
TPL-DT-500-UL142	500	48	53.5	45	56	74	42	4
TPL-DT-600-UL142	600	52	59.5	45	60	82.5	42	4

Optional Supply and Return Pump Sizes

Model	GPH No. 2 Oil	PSI	RPM	HP	Port size
TPL-PM-1	35	100	1750	1/3	1/2
	37	50	1750	1/3	1/2
TPL-PM-2	55	100	1750	1/3	1/2
	57	50	1750	1/3	1/2
TPL-PM-3	78	100	1750	1/3	1/2
	81	50	1750	1/3	1/2
TPL-PM-4	114	100	1750	1/3	1/2
	117	50	1750	1/3	1/2
TPL-PM-5	153	100	1750	1/3	1/2
	159	50	1750	1/3	1/2
TPL-PM-6	210	100	1750	1/2	1/2
	219	50	1750	1/3	1/2
TPL-PM-7	288	100	1750	3/4	3/4
	303	50	1750	1/2	3/4
TPL-PM-8	380	100	1750	3/4	3/4
	405	50	1750	1/2	3/4
TPL-PM-9	532	100	1750	1	3/4
	577	50	1750	3/4	3/4
TPL-PM-10	846	100	1750	2	1-1/2
	888	50	1750	1.5	1-1/2
TPL-PM-11	1188	100	1750	2	1-1/2
	1248	50	1750	1.5	1-1/2
TPL-PM-12	1680	100	1750	3	1-1/2
	1770	50	1750	2	1-1/2